

Stamped Fittings® – Product Specifications

Fabricated 45° Saddle Tap (ST45)

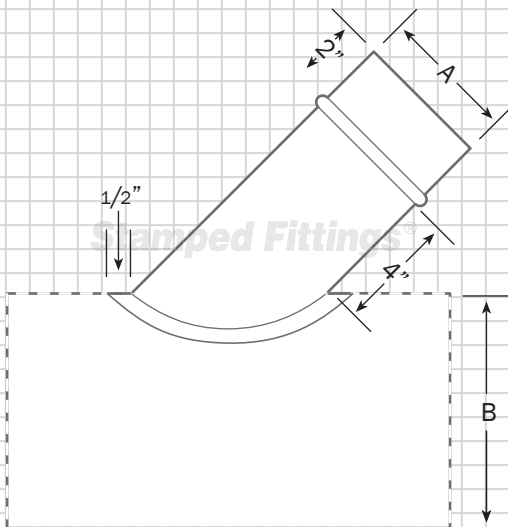

Key

A = Branch size
B = Pipe size

Materials Available

- Galvanized (24 ga.)
- Galvaneal
- SE x +/- 1/2" flange out

Dimensions

(A)	Weight Each
3"	0.92#
4"	1.08#
5"	1.23#
6"	1.54#
7"	1.85#
8"	2.16#
9"	2.77#
10"	3.08#
11"	3.39#
12"	3.70#
13"	4.01#
14"	4.32#

Dimensions

(A)	Weight Each
16"	4.93#
18"	5.55#
20"	6.16#
22"	6.78#
24"	7.40#
26"	9.94#
28"	10.70#
30"	11.47#
32"	12.23#
34"	13.00#
36"	13.76#

Volume Damper (VD)

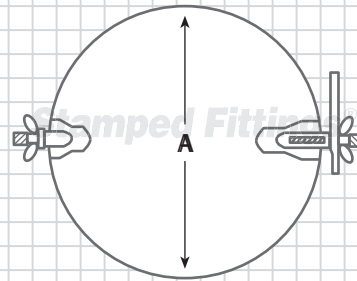

Shown with hardware installed

5/16" hardware and handle
are included (loose)

Key

A = Diameter

Materials Available

- 4" to 12" – Galvanized, 26 ga.
- 14" to 36" – Galvanized, 24 ga.

Options Available

- 2" Stand-off with loose hardware (see spec below)
- Sizes 4" to 10" (all sizes), 12" to 36" (even sizes only)
- VD Kit which includes:
 - 1 - Volume Damper blade
 - 1 - 5/16" washer
 - 2 - 5/16" wingnut washers
 - 1 - Damper handle

OPTION: 2" Shaft Extension

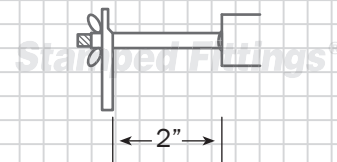

Specs

- 5/16" OD shaft extension
- 1 - 3/4" plastic sleeve
(.875" OD x .75" ID x 1.75" length)