

**Gasket Reducing Conical Cross (GRCC)**

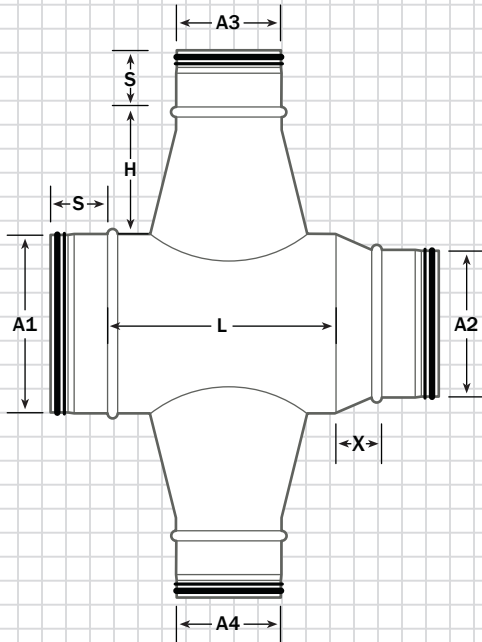

**Gasket Reducing Straight Cross (GRCS)**

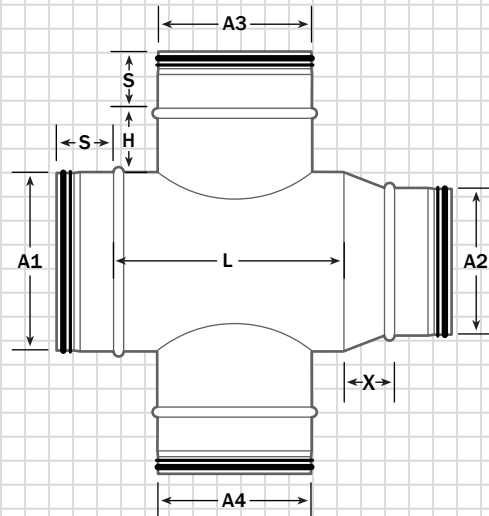

**Gasket Reducing 45° Lateral Cross (GRCL)**

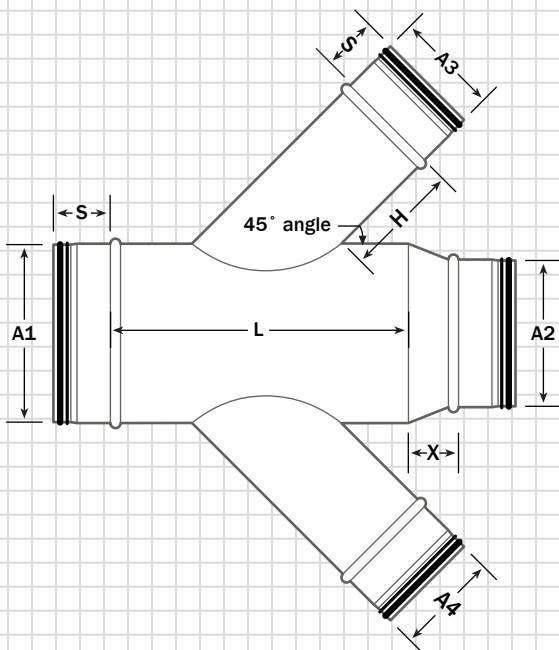

**Key (All)**

Sizes available for A1, A2, A3 & A4:  
 4"-10" (all sizes), 12"-60" (even sizes only)  
 A1 is greater than A3 & A4 (= 2" min.)  
 A2 is less than A1  
 A3 is greater than or equal to A4  
 S = 2"  
 X = A1 - A2 (4" minimum)

**Key (GRCC)**

L = A3 + 4"  
 H = 5"

**Key (GRCS)**

L = A3 + 4"  
 H = 2"

**Key (GRCL)**

L = (A3 x 1.414) + 4"  
 H = 4"

**Gauge**

4" - 24" = 24 ga.  
 26" - 36" = 22 ga.