

## 90° Die Stamped 1.0 CLR Flangeless Elbow (DSE190)

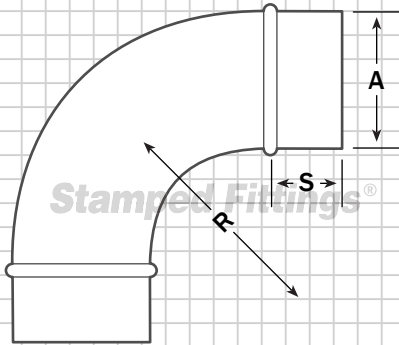

## 45° Die Stamped 1.0 CLR Flangeless Elbow (DSE145)

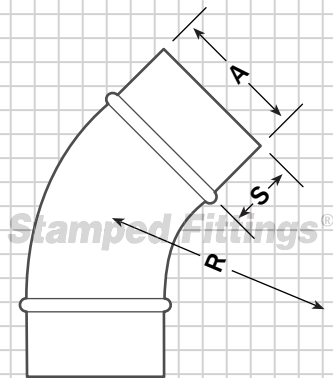

### Key

A = Diameter, nominal size  
 R = 1A (centerline radius)  
 S = 2"

### Materials Available

- Galvanized (4" - 10"), 24 ga.
- Galvanized (12"), 22 ga.

Flangeless elbows are continuously stitch welded on the throat and heel from end to end (past the bead).

### Dimensions

| (A) | 90° (R) | Wt. Per 90° Elbow | 45° (R) | Wt. Per 45° Elbow |
|-----|---------|-------------------|---------|-------------------|
| 4"  | 4.0"    | 0.8#              | 4.0"    | 0.5#              |
| 5"  | 5.0"    | 1.0#              | 5.0"    | 0.6#              |
| 6"  | 6.0"    | 1.4#              | 6.0"    | 1.0#              |
| 7"  | 7.0"    | 2.0#              | 7.0"    | 1.2#              |
| 8"  | 8.0"    | 2.4#              | 8.0"    | 1.6#              |
| 9"  | 9.0"    | 3.0#              | 9.0"    | 2.0#              |
| 10" | 10.0"   | 3.8#              | 10.0"   | 2.6#              |
| 12" | 12.0"   | 7.0#              | 12.0"   | 4.0#              |